



VRLA Rechargeable Battery

UPS 12620W

FEATURES

- Maintenance free
- Non-spillable battery with Absorbing Glass Matt technology (AGM)
- No water topping-up required
- Low self-discharge, less than 3% per month
- Can be used both in vertical and horizontal orientation (excluding used inverted)
- Service Life — 12 Years. According to Eurobat (20 °C) — Long Life

APPLICATIONS

- UPS
- Telecommunications
- Power plants
- Maritime transport
- Cable TV



SPECIFICATIONS

Nominal Voltage	12 V
Nominal Capacity	155 Ah
Approx. weight	45.5 kg (100.31 lbs.)
Terminal type	I3
Internal Resistance	≤ 2.7mΩ (fully charged)
Max. Charge Current	45.0 A
Operating Temperature Range	Charge: 0°C~50°C (32°F~122°F) Discharge: -20°C~60°C (-4°F~140°F) Storage: -20°C~50°C (-4°F~122°F)
Container Material	ABS (UL94-HB)
Life of Service	12 years

ISO 9001	
ISO 14001	
UL	
CE	
<ul style="list-style-type: none"> ● IEC60896 ● JIS C 8704 ● GB/T 19638 	

Dimensions

Outer dimensions

Terminal types

- **Length:**
344±2.0 (13.54±0.08)
- **Width:**
173±2.0 (6.81±0.08)
- **Container height:**
270.5±2.0 (10.65±0.08)
- **Overall height:**
277±2.0 (10.91±0.08)

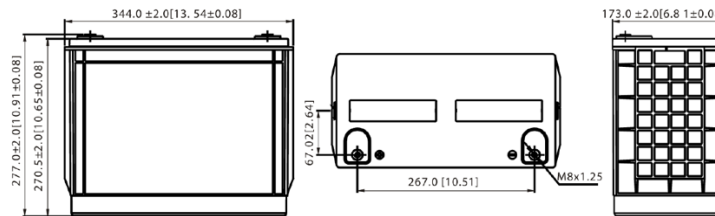

Terminal I3

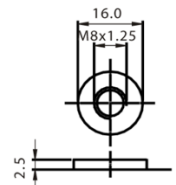

Torque: I3 (10.0 Nm ± 5%)

Constant power discharge characteristics at 25°C / 77°F Unit: W

Final Voltage, V/cell	Discharge time									
	5 min.	10 min.	15 min.	20 min.	25 min.	30 min.	40 min.	50 min.	60 min.	90 min.
1.80V	4746	3981	3277	2740	2375	2086	1679	1409	1221.1	868.0
1.75V	5196	4226	3467	2847	2446	2139	1714	1438	1240.0	881.8
1.70V	5612	4400	3586	2921	2494	2173	1738	1455	1253.8	892.1
1.65V	5994	4536	3667	2976	2533	2198	1758	1471	1265.8	899.0
1.60V	6150	4623	3720	3016	2564	2218	1776	1483	1276.2	904.2

Constant current discharge characteristics at 25°C / 77°F Unit: A

Final Voltage, V/cell	Discharge time									
	5 min.	10 min.	15 min.	20 min.	25 min.	30 min.	40 min.	50 min.	60 min.	90 min.
1.80V	430	350	284	234	200	174	140	117	102.6	72.9
1.75V	473	375	300	245	208	181	143	121	104.2	74.1
1.70V	516	401	310	251	214	184	146	122	105.4	74.9
1.65V	565	424	319	257	217	188	148	124	106.4	75.6
1.60V	598	446	324	260	220	189	150	126	107.1	76.1

The manufacturer reserves the right to make changes due to ongoing optimization activities.